

# THEIA



18/1825.xx

18/1826.xx

18/1827.xx

18/1828.xx

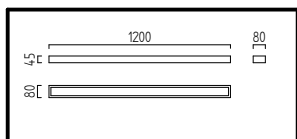
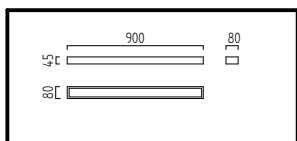
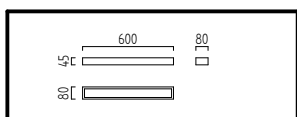
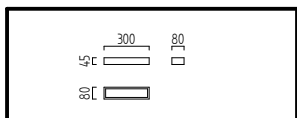
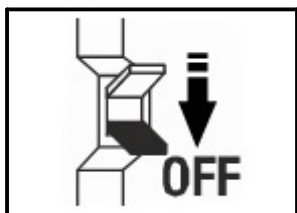
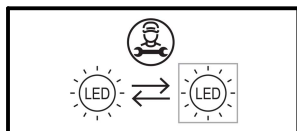
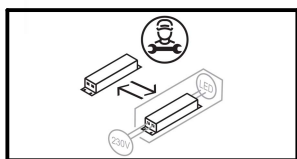

18/1825 - L= 200mm  
18/1826 - L= 400mm  
18/1827 - L= 700mm  
18/1828 - L=1000mm

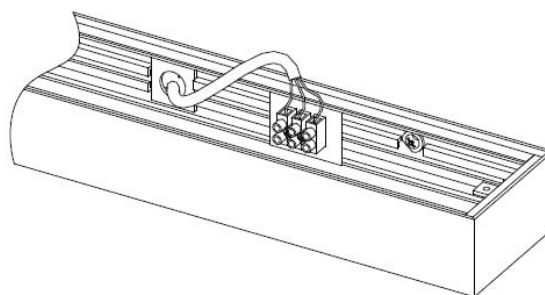
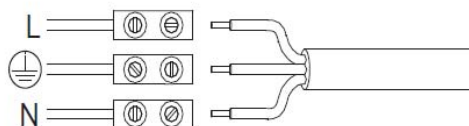
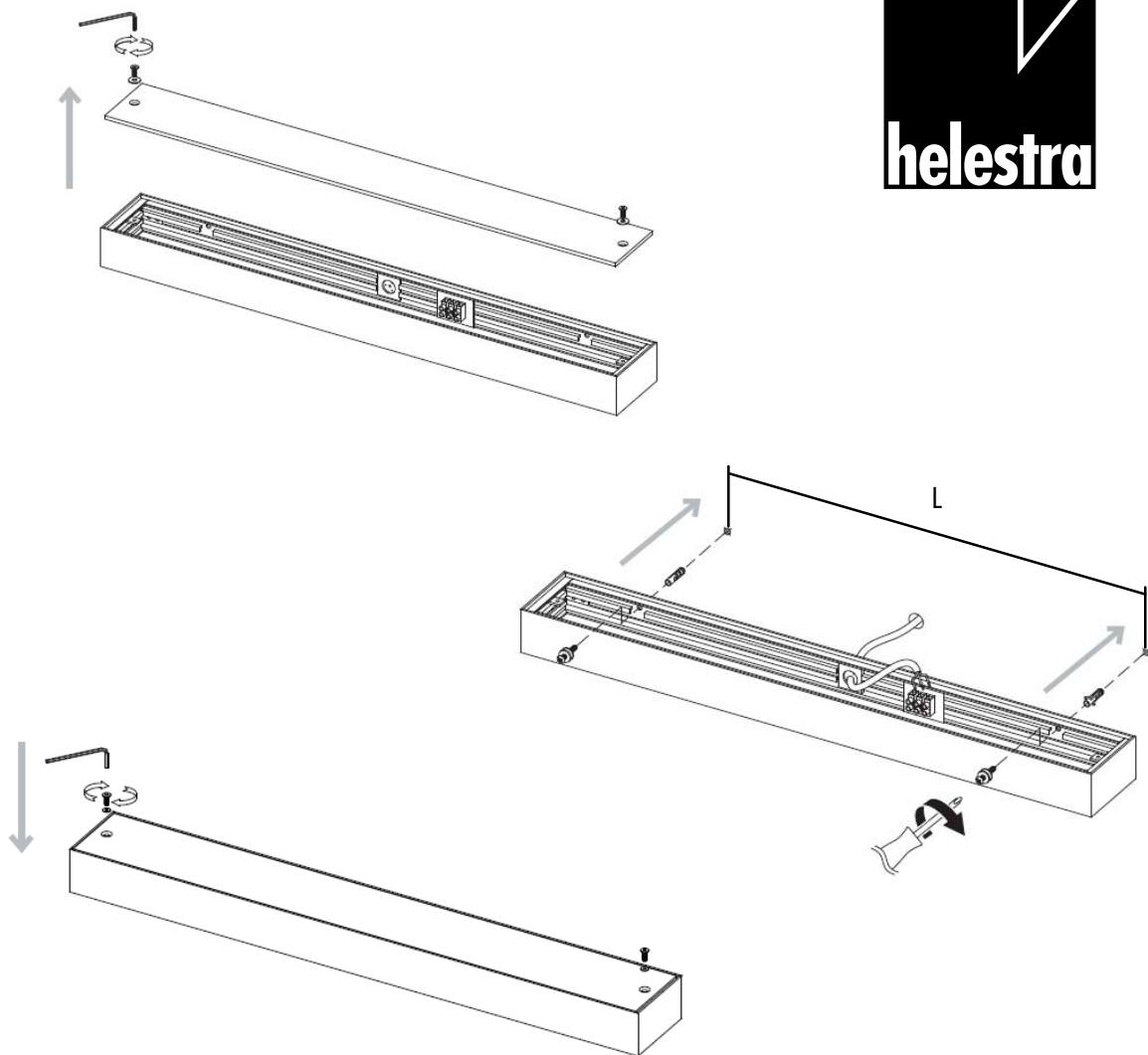

Bitte beachten Sie unsere allgemeinen Hinweise !  
Please observe our general information !  
Nous vous prions d'observer nos instruction générale !  
Observe por favor nuestra informacion general !



Dieses Produkt enthält eine Lichtquelle der Energieeffizienzklasse F.  
This product contains a light source of energy efficiency class F.  
Ce produit contient une source lumineuse de classe d'efficacité F.



[www.helestra.de/installation](http://www.helestra.de/installation)

**Helestra Leuchten GmbH**

An den Breiten 7, 01454 Leppersdorf, Deutschland/Germany

[www.helestra.de](http://www.helestra.de)